

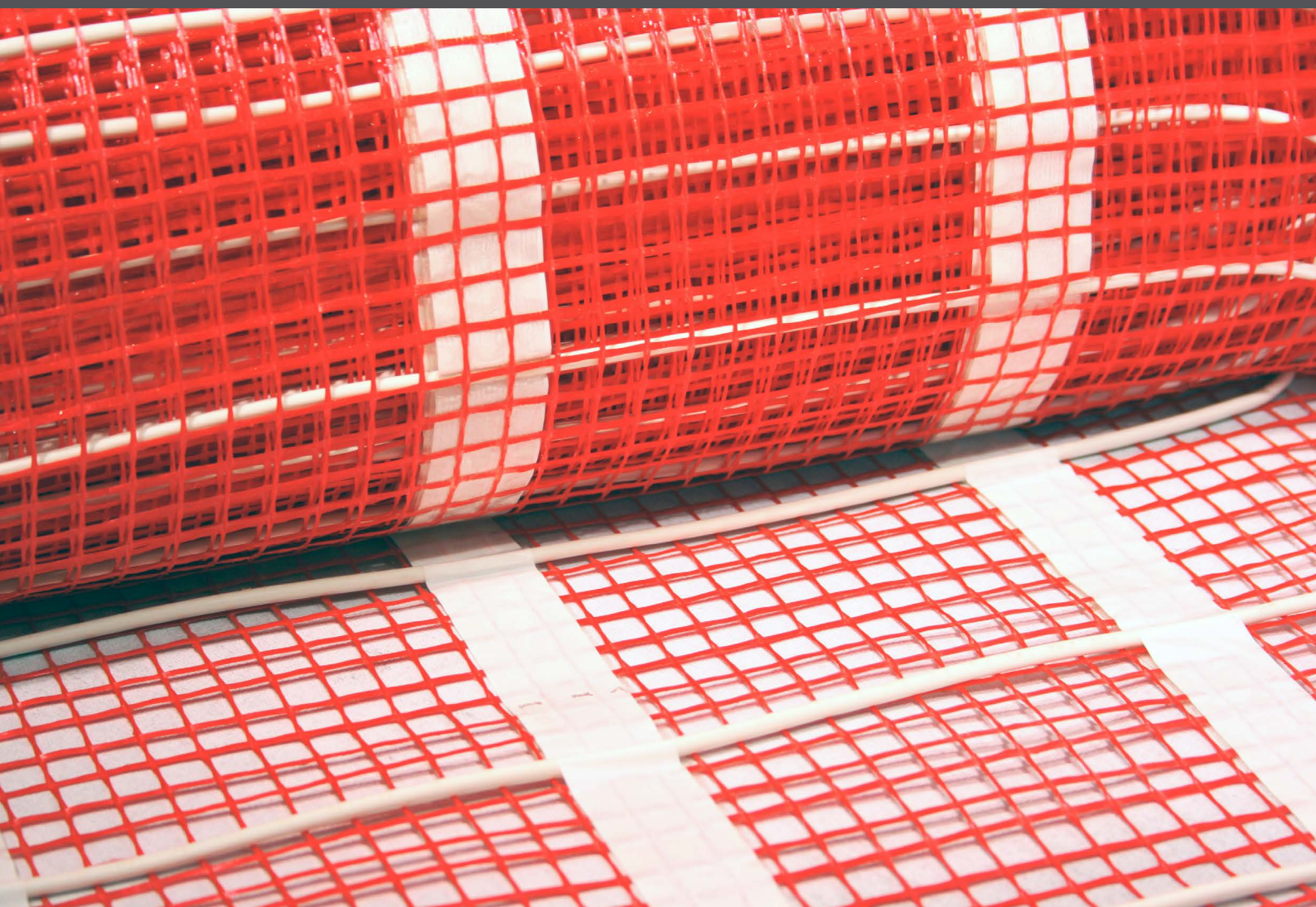

UNDERFLOOR HEATING INSTALLATION GUIDE



Don't forget to activate your warranty within 60 days of purchase.
Visit orbry.com/warranty.

UNDERFLOOR HEATING MAT INSTALLATION GUIDE

- Ensure the sub-floor is dust free, level, and solid.
- ↓
- Lay Orbry Tile Backer Insulation Boards (see Orbry Floor Fixing Guide for more details).
- ↓
- You can now begin to roll out the mat. See page 3 to aid in turning the mat.
- ↓
- The floor sensor can now be positioned half way between two runs of the heating cable (see diagram below). Ensure the sensor does not cross any heating cable and is placed approximately 40cm into the floor.
- ↓

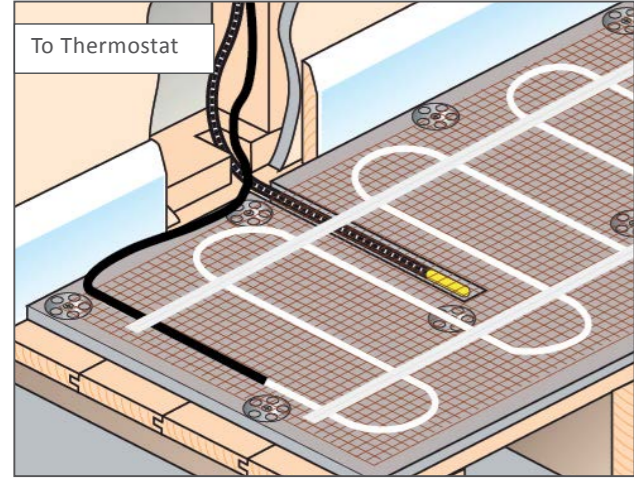

- ↓
- Once in position, use the mat's adhesive backing to fasten to the floor.
- ↓
- Schematic Wiring Layout**

Orbry thermostats are floor sensing so can be positioned anywhere within 3m of the system, subject to current electrical regulations.

- IMPORTANT THINGS TO REMEMBER:**
- ! Each system should be tested with a multimeter before it is unpacked to ensure it is in full working order. Compare the reading with the resistance reading on the mat label.
 - ! It is recommended that you draw a plan of your floor to show how the mat is intended to fit.
 - ! Multiple mats can be installed in one room, however they must be connected in parallel.
 - ! All tile adhesives and grout must be suitable for use with underfloor heating (Orbry recommends the use of a single-part flexible tile adhesive).
 - ✓ This heating cable can be removed from the mesh and laid loosely in awkward areas.
 - ✓ This cable can be secured to the floor using a hot glue gun or tape.

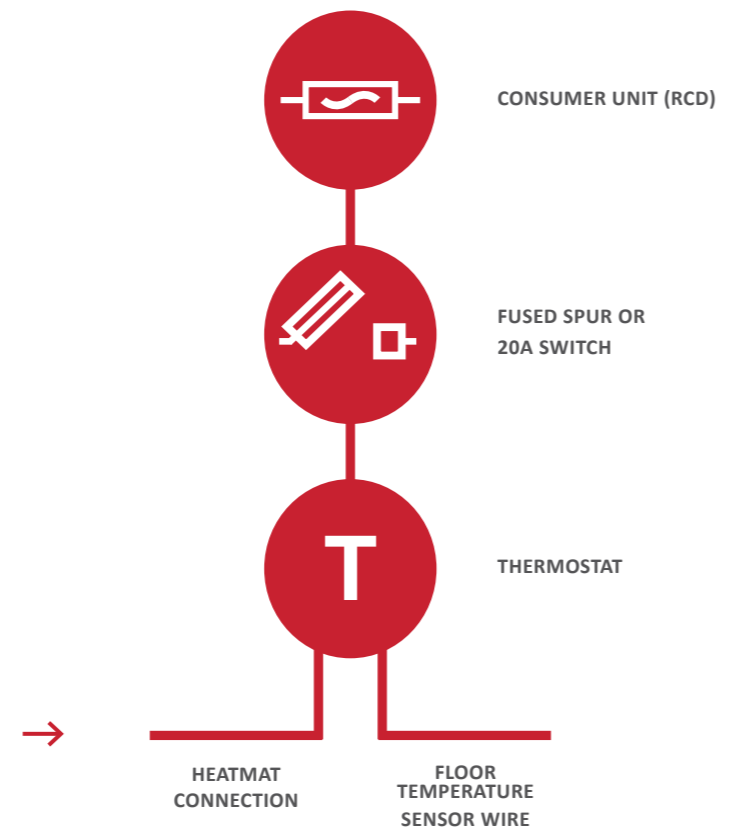

ATTENTION! DO NOT CUT OR SHORTEN THE HEATING ELEMENT!

TURNING THE HEATING MAT

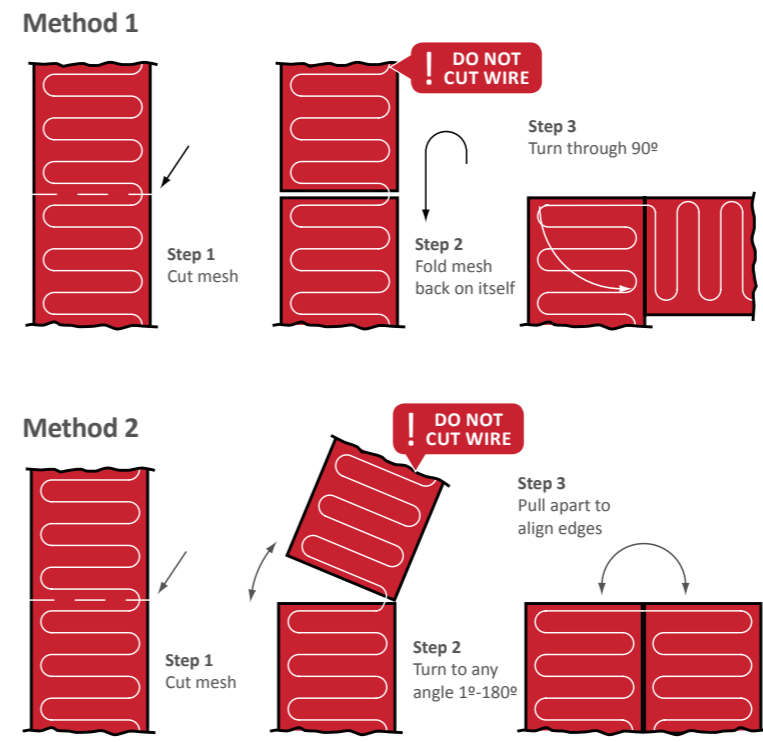

- ! **ELECTRICAL INFORMATION**
All electrical work must conform to current IEE wiring regulations and be checked or carried out by a qualified electrician. Electrical installation work in dwellings is subject to building regulations Part P.
- ! **DO NOT CUT WIRE**
Cutting or shortening the wire will increase the resistance causing it to overheat and eventually burn out.
- ! Ensure all heating cables and connectors are completely covered with tile adhesive.

LAYING THE HEATING MAT

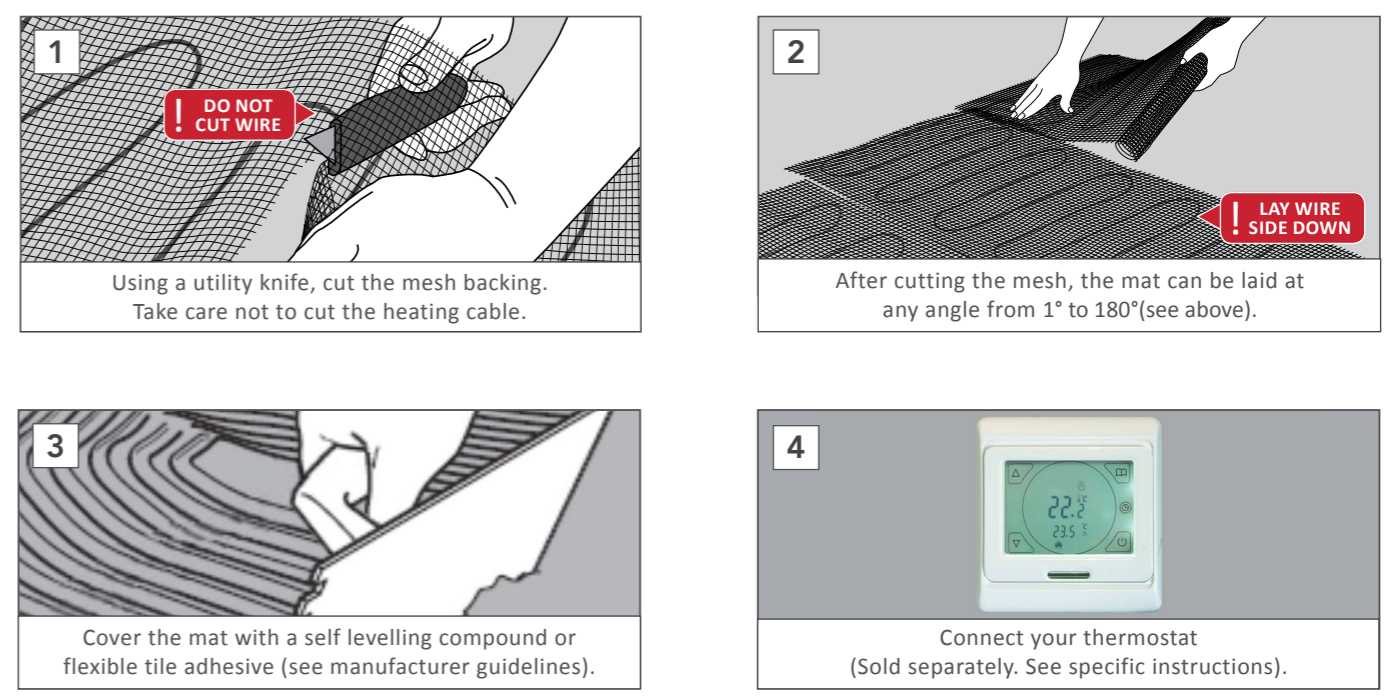

TECHNICAL INFORMATION

150W/m² UNDERFLOOR HEATING MAT

Stock No.	Heat output (w)	Area (m ²)	Resistance (Ω)	Voltage (v)
OBUH150-1	150	1	352.7	230
OBUH150-1-5	225	1.5	235.1	230
OBUH150-2	300	2	176.3	230
OBUH150-2-5	375	2.5	141.1	230
OBUH150-3	450	3	117.6	230
OBUH150-4	600	4	88.2	230
OBUH150-5	750	5	70.5	230
OBUH150-6	900	6	58.8	230
OBUH150-8	1200	8	44.1	230
OBUH150-10	1500	10	35.3	230
OBUH150-12	1800	12	29.4	230

THERMOSTAT

Stock No.	Description	Max load (A)
OBUHTOUCH	Orbry Fully programmable Touchscreen Thermostat, complete with floor sensor	16
OBUHMAN	Orbry Manual Thermostat, complete with floor sensor.	16

Don't forget to activate your warranty within 60 days of purchase.
Visit orbry.com/warranty

10 YEAR WARRANTY

web: www.orbry.com

tel: 0845 208 0221

email: info@orbry.com